

# We build long lasting relationships...

# Robust Fast & Flexible



## NIKITHA BUILD-TECH PVT. LTD.,

Corporate Office:  
No. 602, 6th Floor,  
BRIGADE RUBIX,  
No.20, Yeshwantpur,  
HMT Campus, BANGALORE - 560 022.  
INDIA.  
Tel: +91 80 39990100 -198  
Telefax: +91 80 39990102  
Email: sales@nikithabuildtech.com

www.nikithabuildtech.com

Works:  
# 113/114,  
KIADB Industrial Estate,  
Antharasanahalli,  
TUMKUR - 572 106.  
INDIA.  
Tel: +91 0816 2211 368  
TeleFax: +91 0816 2211 367

www.nikithabuildtech.com



## INTRODUCTION

Welcome to NIKITHA, one of India's leading names in pre-engineered steel buildings and a preferred choice among large, medium & small enterprises.

Since 1994, NIKITHA, has established an excellent track record of delivering over 1500 high quality pre-engineered steel buildings on a turnkey basis, with an in-house capability to provide end-to-end solutions - from design to installation. NIKITHA buildings reflect contemporary design and fabrication that conform to international standards and ensure functionality, aesthetics and durability of our PEB structures.

Our processes are aimed at delivering customer delight at every stage of the project. Team NIKITHA works closely with customers to understand and surpass expectations in an effective and efficient manner. A testimony to this is the confidence reposed by majority of our existing customers with repeat orders - time and again!

Custom designed PEB structure is an innovative solution for a wide range of fast track projects like Large warehousing facilities, Manufacturing facilities of varying complexities, Educational institutions, Engineering industries, Aircraft hangers, Spiritual convention centres, Parking facilities etc.

Pre-engineered Steel Buildings consist of both primary steel structural frames and secondary structural members provided with suitable roofing, side cladding, and water down take arrangements, installed on a concrete foundation. These buildings are strong, cost effective, easy-to-install and are designed to have an excellent aesthetic appeal. Pre-engineered steel buildings have an inherent resistance to earthquake, easy to maintain, alter and expand.

## State-of-the-art manufacturing facility

NIKITHA, headquartered in Bangalore is an ISO 9001: 2008 and ISO 14001: 2004 Certified Organisation with state-of-the-art manufacturing facility measuring about 10000 sq.m with an annual capacity of 20,000 MTPA at Tumkur for primary steel structures like H-Beams, Rafters as well as Secondary Members like 'C' & 'Z' Purlins, Roof and Wall Cladding Sheets, Accessories and Turbo Ventilators.

## ADVANTAGES OF PEB

- Faster manufacturing and installation.
- Low Initial Investment
- Low Maintenance Cost
- Large Clear Spans
- Inherent Resistance to Earthquakes
- Ease of Future Expansion
- Unique & Aesthetic Appearance
- Infinite Choice of Layouts
- Pre-Engineered Steel Buildings can be fitted with different structural additions like: Mezzanine Floors, Fascia, Canopies, & EOT Crane Systems as per client's requirements.

## APPLICATIONS OF PEB

- Dry Warehouses
- Refrigerated Warehouses
- Food Processing Facilities
- Textile & Garment Mfr. Plants and Warehouses
- Auto Component Mfr. Facilities
- Retail Distribution Warehouses
- Educational Institutions
- Transportation: Air, Rail & Bus Maintenance Hangers
- Convention Halls
- Sports Complexes





# Building Features

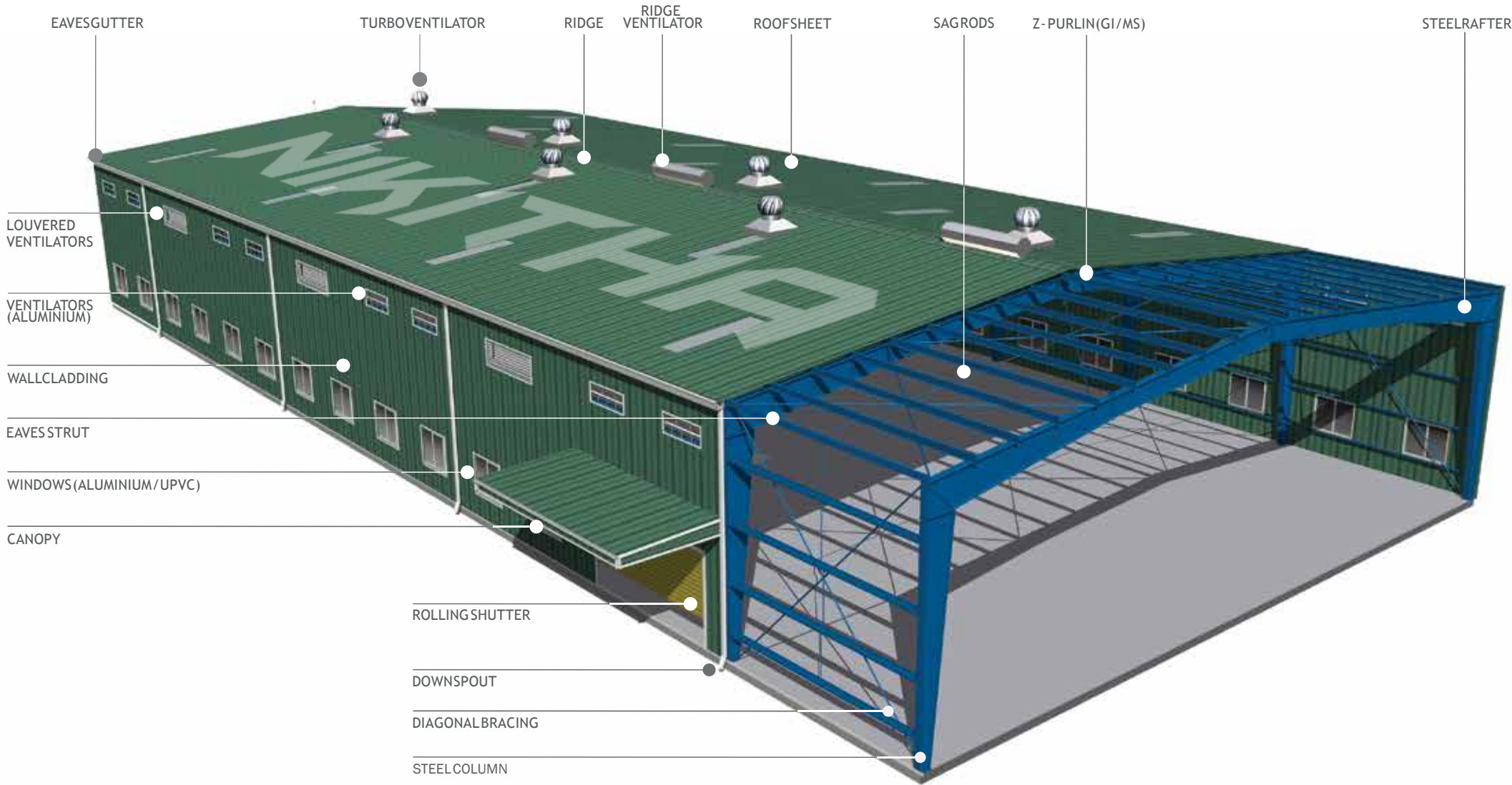

TYPICAL 3D VIEW OF A PRE-ENGINEERED STEEL BUILDING

## Building Boundaries

Parameter	Characteristic	Value
Single Span	Widest	60 Metres
Structure Height	Tallest	40 Metres
Bay spacing	Widest	12 Metres
Mezzanine	Max. Live Load	5 MT/Sq.Mtr
EOT Crane	Crane Capacity	75 MT
JIB Crane	Cantilever	6 Metres
Roof Top Solar Installation	Additional Load	25Kg/Sq.Mtr
Dome Structure	Diameter	36 Metres



# Few Prestigious Projects



Carborundum Universal Ltd, Cochin



S & S Design- Tumkur



Vidyalankar Institute of Technology-Mumbai



HEC India LLP(KIA Motors Plant),Ananthapuram,AP



Davangere-Glass house



Sicoma Mixers India Pvt Ltd- Tumkur



K.L.Raghavendra- Dabaspeta



West Africa (Senegal)



Team Thermo- Dabaspeta



Precimeasure- Dabaspeta



Cattle Shed- Davangere



Glass House- Mysore



SLNT Food Industry- Tumkur



JJM Medical Collage- Davangere



Filcoms- Tumkur

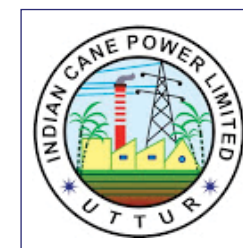

## VISION

To be a global leader in Pre-Engineered Buildings to deliver end to end Solutions with highest quality and cost effective products/services by adding value to stakeholders, inspiring leadership with exemplary business ethics.

## MISSION

To offer high quality pre-Engineered buildings with State-of-the-art technology and providing an excellent platform for the growth of employees.



# Customer Footprint

## Our Projects Pan India

Karnataka  
Himachal Pradesh  
Uttarakhand  
Uttar pradesh  
Gujarat  
Madhya pradesh  
West Bengal  
Maharashtra  
Andrapradesh  
Goa  
Tamilnadu  
Jammu & Kashmir  
Kerala

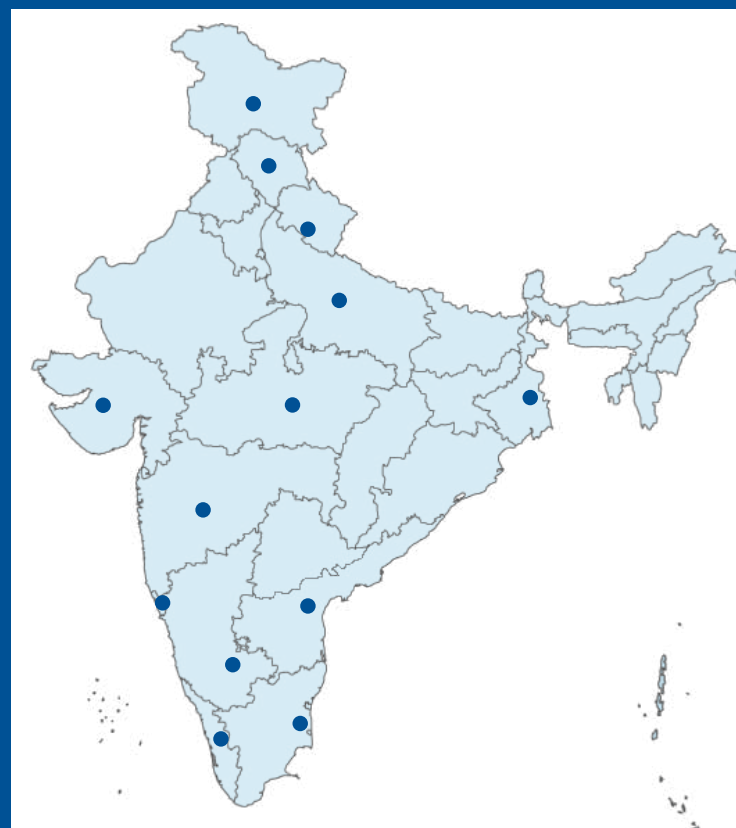

## Overseas Clients

Elgi Tread Ltd, Brazil  
Coco Cola, Tanzania.  
Nile Perch, Tanzania  
Syngenta Seeds, Bangladesh  
Icon Impex, Sri Lanka  
Le Chocolate, Sri Lanka  
Compagnie Sucriere Senegalaise - Senegal  
Raj Brewery Pvt Ltd - Nepal.



## General Engineering

Wipro Ltd. - Bangalore, Hindupur, Tumkur  
Hawa Valves (India) Pvt Ltd, Mumbai  
Rinac India Ltd.- pan India  
Fouress Engineering (India) Ltd. - Bangalore  
Precimeasure Controls Pvt Ltd.- Dabaspet  
Garware Elastomerics Ltd. - Satara  
Hi- Tech Blow Moulders - Coimbatore, Vijayawada, Bangalore & Mangalore  
Afcons Infrastructure Ltd - Jammu & Kashmir.

Lakshmi Group - Coimbatore  
Gravita India Ltd, Chittor  
Rollwell Conveyors Ltd. - Hindupur  
Evershine Granites Pvt. Ltd. - Kuppam  
Laxmi Hydraulics Pvt. Ltd. - Solapur

## Automobile

TVS Motor Company Limited, Hosur  
HEC India LLP (Kia Motors Plant), Ananthapuram, AP  
SMCC Construction India Ltd (Honda plant), Kolar

Volvo India Ltd- Bangalore  
Alstom Transport India Ltd- Sricity, Tada  
Carborundum Universal Ltd- Chennai  
Star Auto Industries Pvt Ltd- Dharwad & Uttarakhand  
RNS Group- All over Karnataka  
G I Auto Pvt Ltd- Bangalore  
Satrac Engineering Pvt Ltd- Dabaspet  
Ghagte Patil Transports Ltd- Bangalore  
Sagar Automobiles- Bangalore  
Elgi Tread India Ltd- Coimbatore  
Lakshmi Hyundai- Bangalore  
TVS Motor Company Limited, Hosur  
HEC India LLP (Kia Motors Plant), Ananthapuram, AP  
SmCC Construction India Ltd (Honda plant), Kolar

## Cold Warehousing

Blue Star Ltd. - Chennai, Bangalore & Hyderabad  
MTR Foods Ltd. - Bangalore  
IQF Foods Pvt Ltd- Bangalore  
I. F. C. Overseas - Pune  
Chaitanya Cold Storage Pvt. Ltd. - Bangalore  
Rich Kwaliti Products Pvt. Ltd. - Pune  
Kappec (APMC)- BIJAPUR  
Fresco Food- Hassan  
Air India SATS - Bangalore  
Prime Refrigeration- Bnagalore  
Ulka Seafoods Pvt. Ltd.- Goa  
Bengal Fisheries Ltd. - Kolkata  
Rich Kwaliti Products Pvt Ltd. - PUNE

## Dry Warehousing

GATI Logistics Ltd. - Bangalore  
JWR Logistics Pvt. Ltd. - Mumbai  
A. S. Group - Bangalore & Chennai (Hindustan Unilever & APC Warehousing)  
Pattabi Enterprises, Mysore  
Container Corporation of India - Bangalore  
Egwood Industries Pvt. Ltd. - Hyderabad (Hindustan Unilever Warehouse)  
Kalleshwara Rice Industries - Davangere.  
Rajguru Foods Warehouse- Bijapur

## Food Processing Industry

Integrated Food Park (Future Group)- Tumkur  
Sri Krishna Milks Pvt Ltd- Hubli  
Hangyo Ice creams- Hubli  
Indian Cane Power Limited -Mudhol  
ITC Ltd., Bangalore  
United Spirits Limited- Nasik  
Universal Bottler Pvt Ltd- Bangalore  
Saj Flight Services Pvt.Ltd., Air Catering Facility  
Neo Foods Pvt Ltd- Tumkur  
Planet Pickles Pvt.Ltd.,  
SLNT Food Industry - TUMKUR  
Ken Agritech Pvt Ltd  
Intergarden India Pvt Ltd - BANGALORE  
Pepsi Co India Holding Pvt. Ltd.

## Textile Industry

Creative International (Pvt) Ltd  
Fibres & Fabrics International Ltd - BANGALORE & DODDABALLAPUR  
Suryalatha Spinning Mills Limited- Hyderabad  
Chaya Spinning Mills  
Soham Cotspinn Pvt Ltd- Davanagere  
Balu Exports - TIRUPUR  
Infratex - PERUNDURAI  
Eastman Exports - TIRUPUR  
Sabarae International - KARUR  
Ahill Apparels - Erode  
Savi Fabrics - Tirupur  
Century Apparels Pvt. Ltd. - Tirupur

## Pharmaceutical Industry

Serum Institute of India Ltd. - Pune  
Tablets India Ltd. - Chennai  
Torrent Pharmaceuticals Ltd. - Baddi (H.P.)  
Syngene International Ltd- Bangalore  
Universal Pharmaceuticals Ltd. - Pondicherry  
Charak Pharmaceuticals Pvt. Ltd. - Mandya  
Monsanto Chemicals India Ltd. - Silvassa

## Educational Institutions

Vidya Vardhaka Sangha - Bangalore, Mysuru  
JJM Medical Collage - Davangere.  
Outrach School- Bangalore  
Vidyalankar Institute of Technology- Mumbai  
Sri Bhagawan Mahaveer Jain & Cultural Trust- Bangalore  
Delhi Public School - Bangalore  
S. S. Institute Of Medical Science & Research Hospital - Davangere  
Maharani Lakshmi Ammanni College - Bangalore  
Kittur Rani Channamma Residential Sainik School for Girls - Kittur  
Vasavi Educational Trust- Bangalore  
Nettur Technical Training Foundation (NTTF)- Bangalore  
Vidhyalankar Institute of Technologies - Mumbai  
Jain Educational Trust- Bangalore  
JJM Medical Collage - Davangere.  
NTTF -Bangalore.

## Sports Complex

Play Arena Sports & Adventure - Bangalore  
Accolades Badminton & Sports Academy - Bangalore

## Public Sector & Govt Bodies

National Aeronautical Laboratories Ltd. ISRO - Bangalore  
BEL - Bangalore  
BHEL - Bangalore  
NSG Training Centre - Hyderabad  
KRIDL Glass House- Davanagere  
KPWD Glass Hpuse- Mysore  
APMC Warehouse (Cattle Auction Market)- Davanagere  
KHB- Bangalore



# End-to-end Capability



CNC, MULTI-TORCH PROFILE CUTTING



TACK-WELDER



H-BEAM SAW WELDING



MULTI SPINDLE DRILLING



PLATE PROCESSING



THREAD ROLLING



PAINT BOOTH



FINISHED GOODS BAY



DISPATCH



# Manufacturing Facility



HIGH DEFINITION PLASMA CUTTING MACHINE



HIGH DEFINITION PLATE PROCESSING MACHINE



H - BEAM SAW WELDING MACHINE



PURLIN PROFILING MACHINE



## MEZZANINE FLOOR

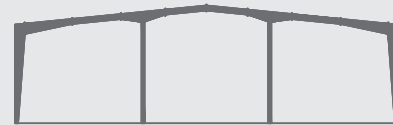

SINGLE SPAN WITH  
TWO INTERMEDIATE SUPPORT (UPTO 72M)



### MULTI-SPAN WITH CRANE LOAD



MULTI-STOREY (UPTO 40M)

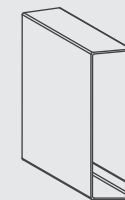

EAVES STRUT

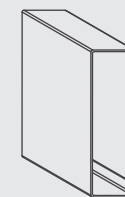

C-PURLIN

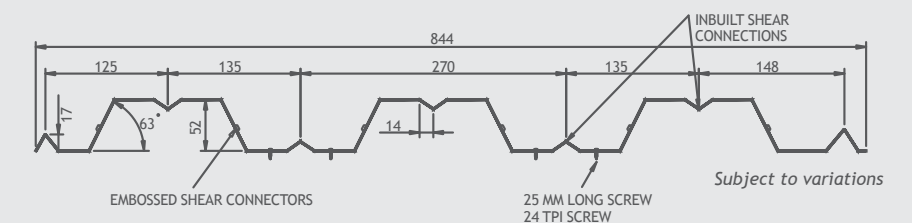
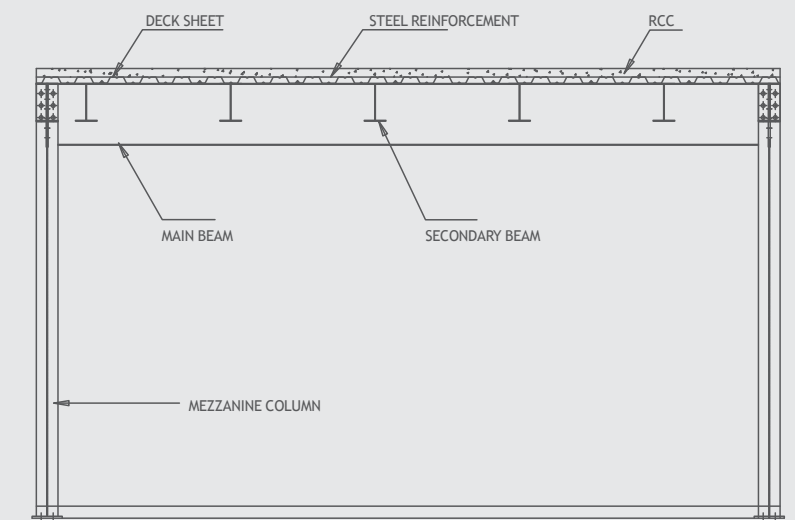

Mezzanine floors are built for light and heavy loadings. Design loads of 300 Kg/Sqm and above. High tensile strength steel Deck sheets are used for fast and easy construction.

## C & Z PURLINS

C and Z Purlin sections are manufactured to stringent quality standards using high quality material. They are offered in various thicknesses and sizes in galvanized or HR Painted finishes according to customer requirements.

## FEATURES

High Definition Laser Cut profile - ensures perfect corners, accurate lengths & structures of proper dimension.

Easy to install    Light weight    Excellent corrosion resistance    Durability and long life

## EAVES STRUT

Eaves Struts provide anti-sag support and are designed to suit building requirement.



# Roof & Cladding Systems

Single skin roofing system  
PUF panel roofing system (thermal insulation)

## ROOFING SYSTEM

### SINGLE SKIN SHEET

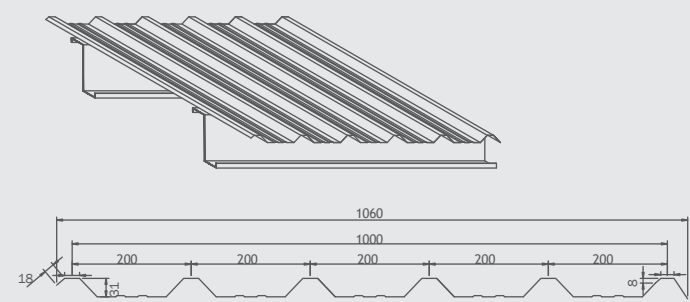

*Subject to variations*

Single skin roofing systems are light weight, high quality, aesthetic, economical and available in bare or customised colours.

### UNDER DECK ROOFING

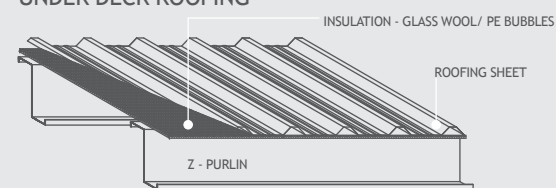

Under Deck roofing systems are clean, light weight, high quality economical thermal insulators.

## CLIP LOCK SHEETS

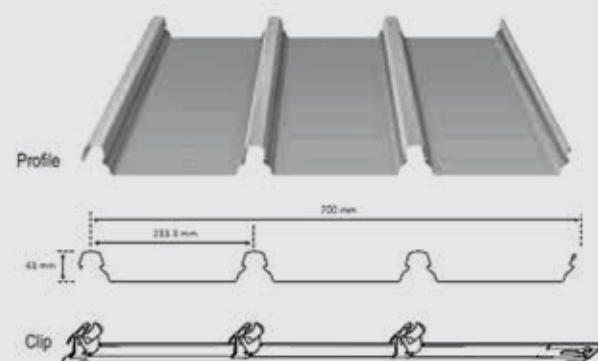

Clip Lock Sheets are light weight & durable. They also offer excellent water proofing characteristics.

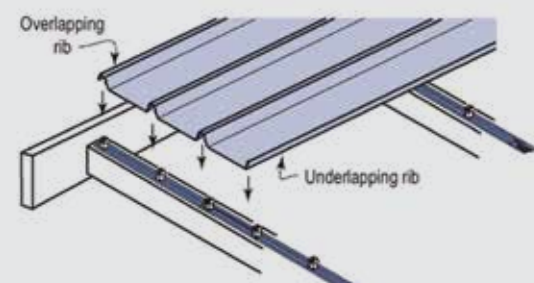

## WALL PANELS

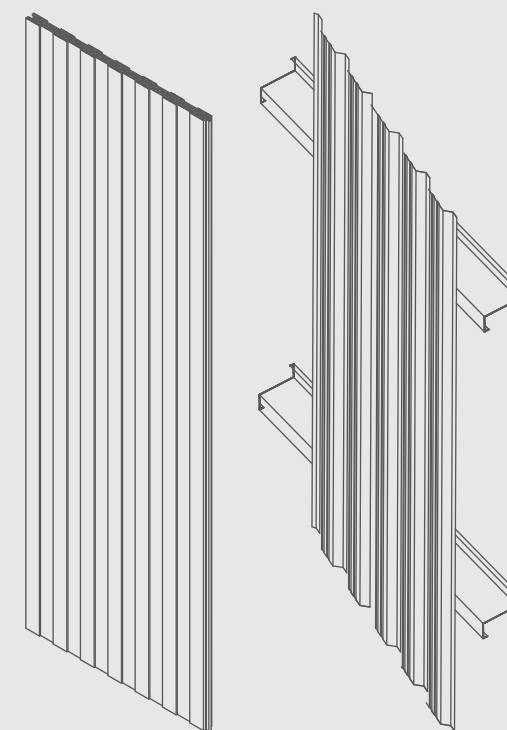

PUF PANEL

Single skin wall panels are widely used in general applications



Alstom-Tada (AP)



Raj Brewery-Nepal

NB - 01

NC - 02

NC - 03

NC - 04

NC - 05

NC - 06

NC - 07

NC - 08

NC - 09

BARE GL

OFF WHITE

SKY BLUE

TAURUS BLUE

CAULIFIED GREEN

MIST GREEN

FLAME RED

BRICK RED

BEIGE

SHEET PROFILING MACHINE

## ROOFING, CLADDING SHEETS & ACCESSORIES

Galvalume Roofing sheets are offered in a wide range of colors, patterns and sizes. They are durable and offer excellent resistance to corrosion and UV rays. For Skylight, Polycarbonate sheets are used for uniform natural light distribution within the building.

Roofing Sheet Accessories include ridges, gutters, external corner flashings, etc. These accessories are available in various sizes and lengths to meet the customized requirements.

## COLOUR SHADES

\*Actual colours may vary.



# Accessories

## Ventilators, Gutters & Down Spouts



CUTTING & SLITTING MACHINE

### Turbo Ventilators

Turbo Ventilators are manufactured inhouse using high quality raw materials under strict quality control. Extensively tested to perform under high pressure environments as they exhaust industrial pollutants such as smoke, dust, gases, humidity, fumes, heat and other minute particles. Proven for their robust construction and free of maintenance, our Turbo Ventilators are recognized for their years of trouble free operation.

### Rain Water Drain System: Gutters And Down Spouts

Gutters collect rainwater from the roof of the building and diverts it away from the structure, typically into a drain. Gutters are manufactured to suit the custom design requirements of each building on the basis of geographic & rainfall data. A downspout is a vertical pipe for carrying rainwater from a rain gutter to ground level. The down spout prevents rain water from collecting around the building foundation and thus protects it from water damage.

# Quality & Testing



ULTRASONIC TEST

MAGNETIC PARTICLE TEST

DYE PENETRATION TEST

### Quality

The entire operation and process of the organization is monitored and integrated by custom built ERP software. Combination of experienced designers with standard design tools like STAAD Pro, 3D design and drafting softwares, Auto CAD, etc., help us to deliver functionally efficient and aesthetically pleasing Pre-engineered Steel Buildings.

With a keen eye for detail, our design engineers make sure that installation bottlenecks are addressed at the design stage itself - thus ensuring a hassle free installation.

The key to Nikitha's high quality and long lasting Pre-engineered Steel Buildings lies in its non-compromising commitment to adherence & implementation of international quality standards. Right from design, raw material procurement, production, & to final project installation.

# Design & Engineering Standards

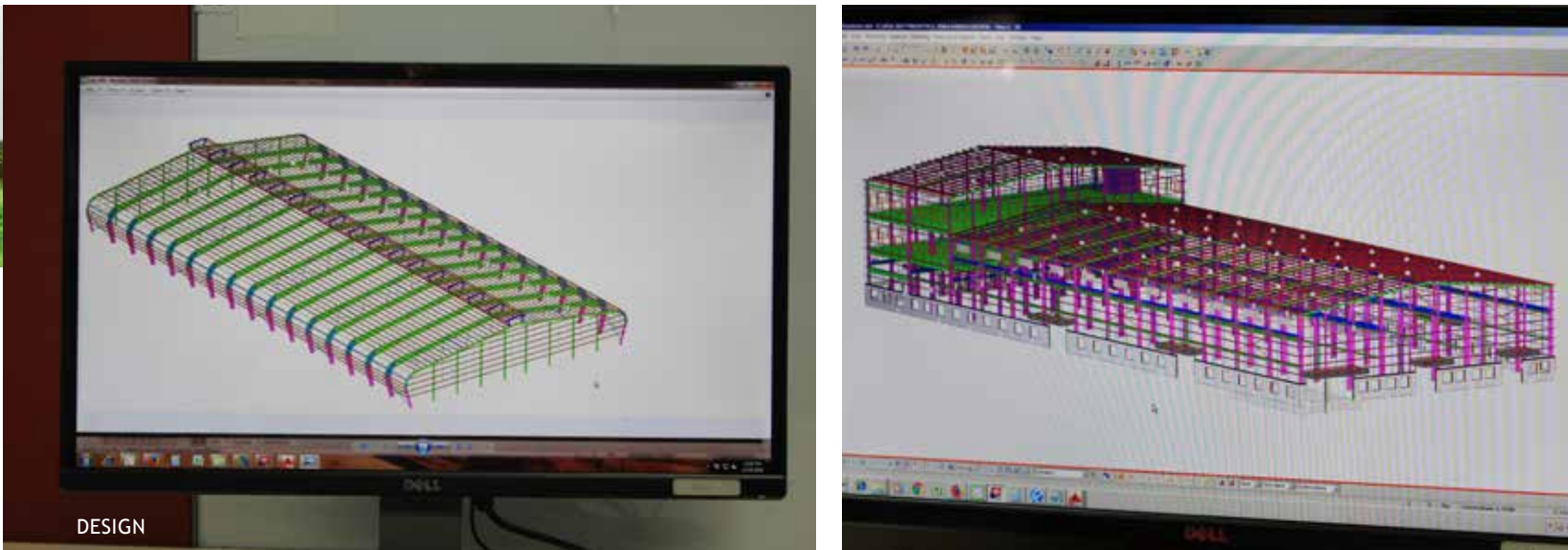

The following standards are followed in the Practice for design, procurement of Raw Materials & total quality control:

	Particulars	Standard	Remarks
DESIGN	Dead Load	IS:875 Part -I	
	Live Load	IS:875 Part-II	
	Wind Load	IS:875 Part-III	
	Snow Load	IS:875 Part-IV	
	Earthquake	IS:1893-2002	As per IS:875 Part-V Load combinations and special loads
	Structural Steel Members Design	IS:800-2007/ AISC-ASD-Manual-1989	
RAW MATERIAL	MS Plates	IS:2062-2011	Yield strength Min 250MPa - max-350 MPA
	Purlins (HR Coils)	IS:10748	Minimum yield strength of 250N/mm <sup>2</sup>
	Purlins (HR Coils)	IS:801-1975 & IS811	Cold formed light gauge steel for structural members in building construction
	GI Purlins	IS:277 & ASTM A653-07	Minimum yield strength of 340-550N/mm <sup>2</sup>
	PPGL Coils	ASTM A792-2010 G80 Class 1	Minimum yield strength of 340-550N/mm <sup>2</sup>
	High Tensile Hex Bolts and Nuts	IS:1363,IS:1363/67 part 3&6.	Grade 8.8
	M S Hex Bolts and Nuts	IS:1363 part 3	Grade 4.8
	Pipe & Tubes	IS:1161 & IS:4923	Yst:210, 240, 310
QUALITY	Welding Procedure Qualification: Other than pre-qualified welding procedure all the other procedures are qualified as per AWS: D1.1(2008)		
	Saw Welding at H-Beam with Twin Arc Technology	IS:816-1969 & IS:9595-1966	Single side or double side welding is optional as per norms
	Plates Ultrasonic Test	ASTM 435	For raw materials
	Splice Joint	IS: 4353-1995	Before Butt Joint Welding with single 'V' & double 'V' Groove preparation
	Splice Joint welding	IS:816	GMAW/FCAW
	Radiography Test as per ASME: Sec. Article 2/ ASME Sec VIII Division 1		
	Ultrasonic Test as per ASME SEC VIII Division 1 or Section 6 - Part P of AWS: D1.1 2010 or latest edition		
	Dye Penetrant Test	ASTM E 165	
	Magnetic Particle Test	ASTM E 709	
	Shot Blasting	ISO 8501. 1:1988 IS:1477-1971 (part1-pretreatment)	SA2.5
	Painting Primer	ASTM D 2794, D 3359-05 & IS:1477-1971(part-II painting)	Min DFT-30 microns
	Finishing cost synthetic Enamel paint	ASTMD2794,D3359-05 & IS:1477-1971 (part-II painting)	Min TCT (DFT)-90 microns.
	Coat with Enamel Paint	ASTM D 2794, D 3359-02	
	Cross Hatch Adheshion Test	ASTM D 3359-02	For rating the acceptance criteria of painted surface

Above mentioned Non-destructive tests, interpretation and evaluation are in accordance with ASNT NDT LEVEL-II and are conducted by qualified & trained personnel only.

\*ASNT--AMERICAN SOCIETY FOR NON-DESTRUCTIVE TESTING

\*ASTM--AMERICAN SOCIETY FOR TESTING OF MATERIAL